



**DS-U00010**

# **Portable Air Compressor**

## **INSTRUCTION MANUAL**



## COMPONENTS



- 1. Start Switch
- 2. Thermometer
- 3. Pressure Gauge
- 4. Explosion-Proof Valve
- 5. Male Quick Connector
- 6. Cooling Fan

- 7. Power Socket
- 8. Female Quick Connector
- 9. Hose
- 10. Release Valve
- 11. Filter
- 12. Wire

**DOMINATOR**

[WWW.DOMINATORINTERNATIONAL.COM](http://WWW.DOMINATORINTERNATIONAL.COM)

**P.1**

## PURPOSE & PARAMETERS

This compressor provides high pressure air for small containers or small sealed spaces . It can be used in shooting sports, stress testing, pipeline leakage detection, diving, fire-fighting and other fields.

**Volume :** 270mm x 205mm x 160mm

**Weight :** 6.5 KG

**Compression Mode :** 3-Stage Compression

**Power Supply :** 12V DC / 110V AC / 220V AC

**Power :** 350 W

**Cooling Method :** Fan Air Cooled

**Inflation Pressure :** 30mpa or 4500psi

**Charging rate :** 20 Min / 0.45 liter tank ,  
0 - 30mpa ( 300 bar )



[WWW.DOMINATORINTERNATIONAL.COM](http://WWW.DOMINATORINTERNATIONAL.COM)

**P. 2**

- 1** Install the Hose and tighten the Release Valve;
- 2** With the car engine running, connect the compressor to the car battery using the cables provided. The car battery must be a 12-volt DC power source . Red connects to the positive ( + ) terminal and black connects to the negative ( - ) terminal. When connected correctly the compressor fan will start automatically . (To protect the compressor and user , the fan will not start if the connections are backwards.)
- 3** Connect air tank or other device to the compressor using the fast connect hose.
- 4** Turn on the compressor by pressing the On/Off switch.
- 5** Manually turn off the compressor when the desired pressure is achieved.
- 6** Separate the tank from the hose.
- 7** Leave the electrical wires connected for 3 minutes before disconnecting to allow compressor to cool .

- 1** The compressor must be turned off if the temperature reaches 80-degrees Celsius . It can be turned on again when the temperature drops below 40-degrees Celsius .
- 2** While the compressor has filled over 5 tanks of 0.5liter gas . Add 1 - 2 drops of oil.



- 3** Drain the waste oil and water from oil drain valve after filled 20 times.



- 4** It needs someone watching the pressure gauge of the machine while working.

When the compressor filled over 40 bottle of 0.5 liter air tanks, the compressor is required to maintain at once.

- 1 Clean up oil
- 2 Clean up carbon
- 3 Replace filter with fiber cotton core

Cleaning and checking these 4 valves can minimize the chance of malfunctioning.

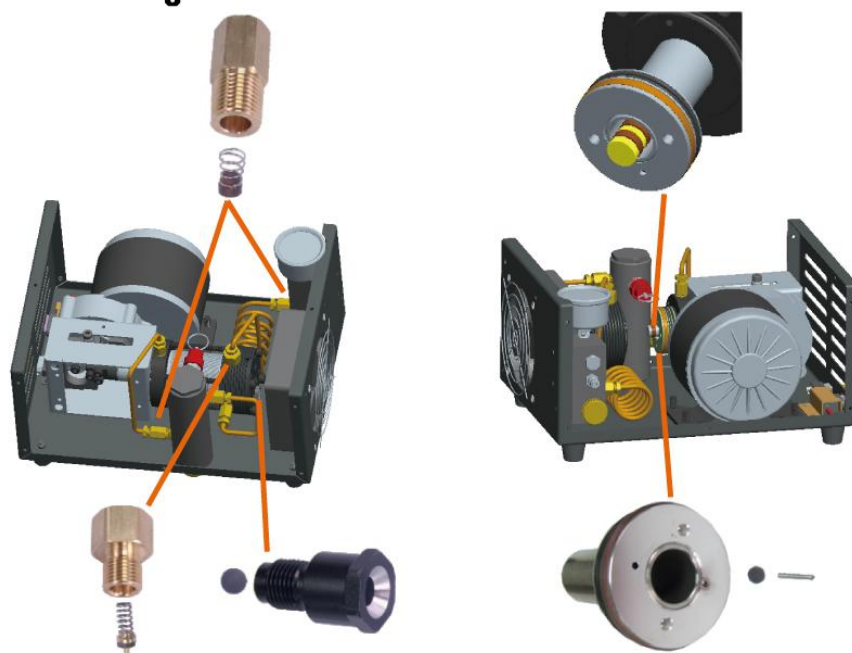



- 1** When the pressure cannot be reached 5mpa:

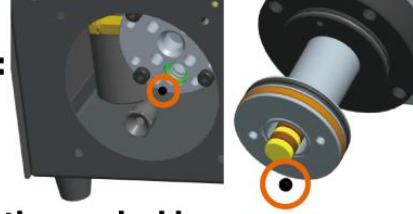

**SOLUTION**

check all the joints , connectors , crews whether are leaking;  
Replace low pressure seal balls and medium pressure seal balls.

- 2** When the pressure rises lowly and the pressure cannot be reacheds 20mpa:

**SOLUTION**

Check all the joints whether are leakings;  
Replace the high pressure piston ring;  
Clean the high pressure check valves.



- 3** When the temperature rises / over heat too fast:

**SOLUTION**

Check the air fan whether it is working.

Do not remove or disassemble the compressor without permission .  
Please contact the local dealer / seller for help immediately .